

GBE/GKE-Series | Brazed Plate Heat Exchangers

THE ECONOMICAL SOLUTION FOR FULL EFFICIENCY



DESIGN & FUNCTION

The GKE/GBE-Series are compact brazed plate heat exchangers designed for hydronics, perfectly suitable for applications with up to 30 bar/435 psi and max. 200°C/392°F. They offer an economical solution for decentralized hot water systems, separating systems and various regenerative applications.

With these high thermal efficient plate heat exchangers, you can handle everything with minimal size and weight for maximal efficiency, quality and profitability.

ADVANTAGES

- ▶ **LOW INVESTMENT COSTS**
- ▶ **HIGH EFFICIENCY**
- ▶ **COMPACT DESIGN**
- ▶ **CONBRAZE®-DESIGN AVAILABLE**
- ▶ **MODULAR DESIGN**

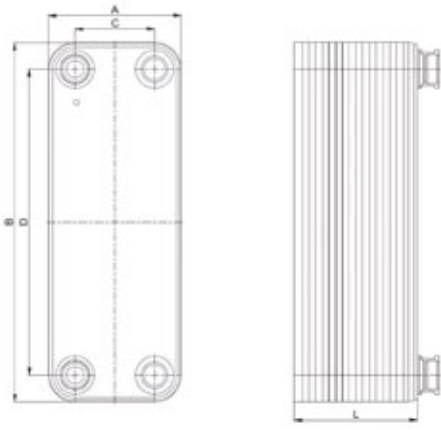

ALWAYS A SUITABLE SOLUTION AT HAND

The brazed plate heat exchangers from Kelvion offer tailor-made solutions for the widest range of application. We configure the most economically favorable model for you from the wide range of available sizes and the numerous optional features. We adapt this with individually positioned connections to meet your specific requirements.

APPLICATION EXAMPLES:

- ▶ Underfloor and conventional heating
- ▶ Potable water heating
- ▶ Hydraulic applications with low pressure

Type	Pressure bar	Dimensions				L-Dimension* [mm]	Weight* [kg]	Volume (Litres/ Channel)	Max. number of plates
		A [mm]	B [mm]	C [mm]	D [mm]				
GBE 100	16/16	74	204	40	170	L=10,50+2,23xN	W=0,45+0,050xN	0.025	50
GBE 200	16/16	90	231	43	182	L=12,50+2,24xN	W=0,50+0,060xN	0.030	50
GBE 220	16/16	90	328	43	279	L=12,50+2,25xN	W=0,65+0,090xN	0.046	50
GBE 240	16/16	90	464	43	415	L=12,50+2,24xN	W=0,80+0,130xN	0.070	50
GBE 400	16/16	124	335	73	281	L=12,50+2,25xN	W=0,80+0,120xN	0.065	50
GBE 500	25/16	124	532	73	478	L=12,50+2,23xN	W=1,15+0,200xN	0.100	100
GKE 108	16/16	74	204	40	170	L=8,0+1,0xN	W=0,40+0,035xN	0.010	50
GKE 228	16/16	90	328	43	279	L=13,0+1,0xN	W=1,20+0,065xN	0.019	50
GKE 550M	30/25	124	532	73	478	L=10,0+1,70xN	W=1,10+0,200xN	0.070	150
GKE 550H	30/25	124	532	73	478	L=10,0+1,66xN	W=1,10+0,200xN	0.070	150

*N = number of plates

SPECIFICATIONS

- ▶ Plate Material: Stainless steel AISI 316L / 1.4404
- ▶ Brazing Material: Copper

FEATURES

- ▶ Full-Flow System™ (models GBE 100, 200, 220, 240, 400, 500)
- ▶ ConBraz® Design (models 108, 228, 550)
- ▶ Safety Chamber™ (model 108, 228)

PERFORMANCE LIMITS

- ▶ Working temperature: -196°C to +200°C / -321°F to +392°F
- ▶ Working pressure: up to 30 bar / 435 psi

APPROVAL

- ▶ PED (CE)
- ▶ ASME VIII-1

We need following information to select your optimum heat exchanger

- ▶ Required temperature range
- ▶ Flow rates or required heat load
- ▶ Maximal permitted pressure drop
- ▶ Required working conditions

The specifications contained in this brochure are intended only to serve the non-binding description of our products and services and are not subject to guarantee. Binding specifications, especially pertaining to performance data and suitability for specific operating purposes, are dependent upon the individual circumstances at the operation location and can, therefore, only be made in terms of precise requests.